

96-Pair 110 Patch Panel CAT 6

PRODUCT SPECIFICATION

Package includes:

- A. 110 Blank Patch Panel, 1 pc
- B. 4-Pair 110 Connecting Block, 24 pcs
- C. Label Holders, 2 pcs
- D. #12-24 x 5/8" Pan Head, Pilot Point Machine Screw, 4 pcs

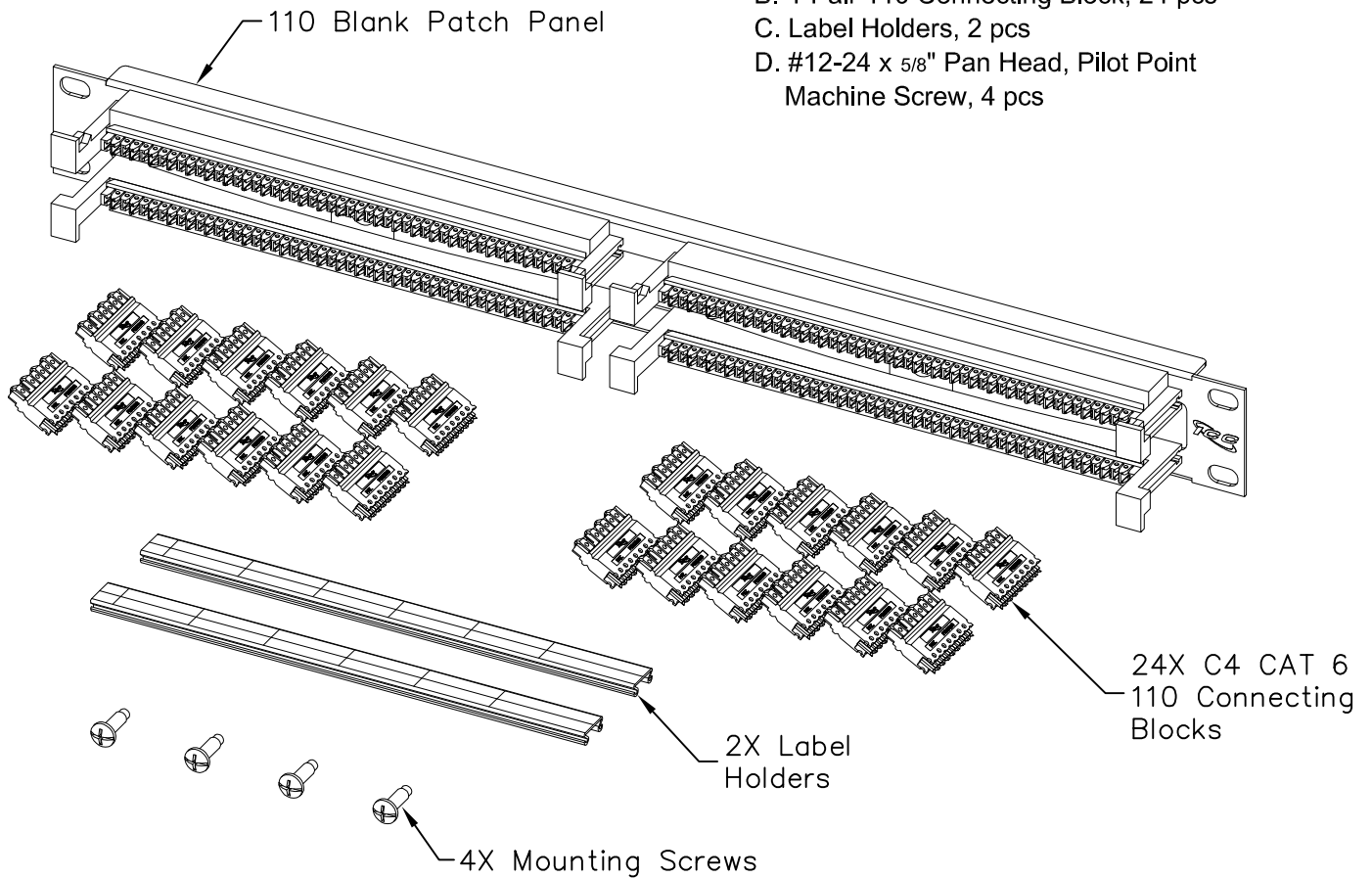

Features and Benefits:

- Rack mounted reinforced steel panel with two 50-pair 110 blocks.
- Designed to support CAT 6 commercial or residential applications.
- Backwards compatible with CAT 5e wiring solutions.
- Ideal for data and voice applications.
- Designed with rear cable entry for flexibility.
- Compatible with all standard 19" racks and cabinets.
- 1 rack mount space (RMS).
- Compatible with ICC's ICACSPDT4P 4-pair punch down tool and IC110TC450 termination caps.
- ANSI/TIA-568-C and UL 1863 compliant

PATCH PANEL, 110, 96-PAIR, CAT 6, 1 RMS

ITEM NO.	IC110PRK61
DWG NO.	PS110PRK61

REV.	B
PAGE NO.	1



CUSTOMER CARE / TECHNICAL SUPPORT * CSR@ICC.COM / 888-ASK-4-ICC (275-4422) * 2100 E. Valencia Dr, Suite D, Fullerton, CA 92831 * www.icc.com

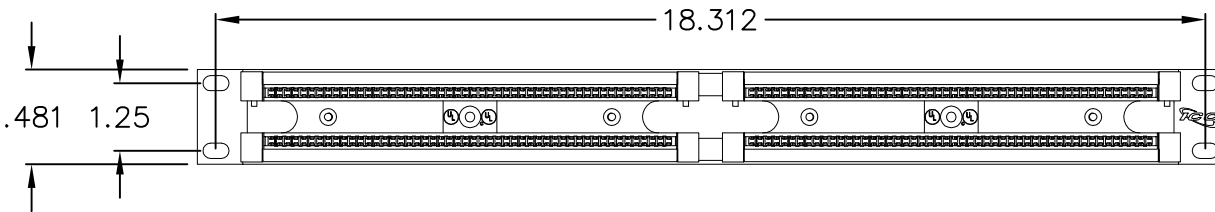
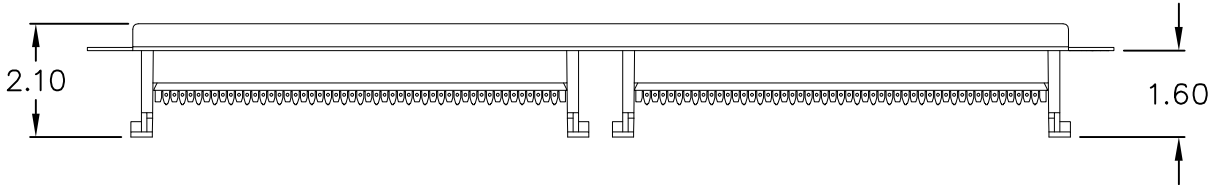
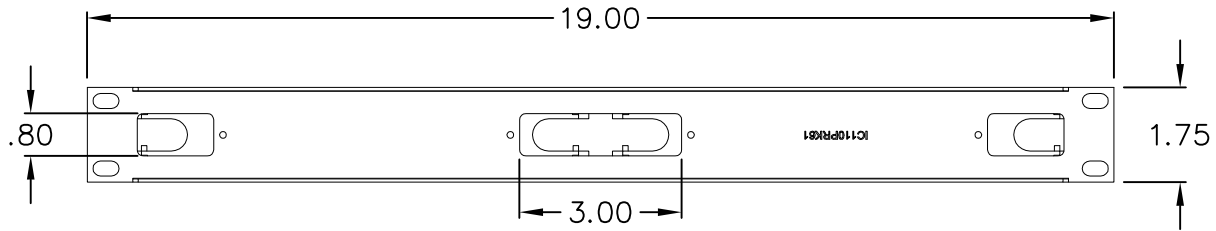

NOTE: UNLESS OTHERWISE SPECIFIED

- 1. 110 BLANK PATCH PANEL:
 - A. MATERIAL: 16 GA CRS
 - B. SURFACE FINISHING: BLACK POWDER COAT
- 2. 50-PAIR 110 BLOCK:
 - A. MATERIAL: PC, UL 94V-0
 - B. COLOR: IVORY

CATEGORY 6 CONNECTING HARDWARE REQUIREMENTS												
FREQUENCY (MHz)	1.0	4.0	8.0	10.0	16.0	20.0	25.0	31.25	62.5	100	200	250
NEXT LOSS (db)	75.0	75.0	75.0	74.0	69.9	68.0	66.0	64.1	58.1	54.0	48.0	46.0
FEXT LOSS (db)	75.0	71.1	65.0	63.1	59.0	57.1	55.1	53.2	47.2	43.1	37.1	35.1
RETURN LOSS (db)	30.0	30.0	30.0	30.0	30.0	30.0	30.0	30.0	28.1	24.0	18.0	16.0
INSERTION LOSS(db)	0.10	0.10	0.10	0.10	0.10	0.10	0.10	0.11	0.16	0.20	0.28	0.32

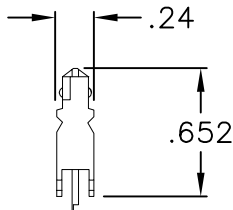
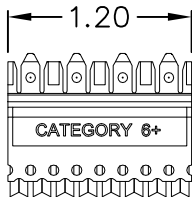
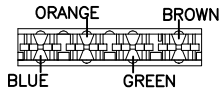

110 CONNECTING BLOCK

- 1. 4-PAIR CONNECTING BLOCK:
 - A. HOUSING: PC, UL94V-0
 - B. IDC PHOSPHOR BRONZE ALLOY PLATED WITH 100 MICRON TIN PLATED
 - C. MECHANICAL:
 - NUMBER OF TERMINATIONS ≥ 200
 - GAUGE: 22~24 AWG
 - WIRE: SOLID



PATCH PANEL, 1 10, 96-PAIR, CAT 6, 1 RMS		 Premium Products <i>Proven Performance</i> <i>Competitive Prices</i>	
ITEM NO.	IC110PRK61		REV. B
DWG NO.	PS110PRK61	PAGE NO.	2

CUSTOMER CARE / TECHNICAL SUPPORT * CSR@ICC.COM / 888-ASK-4-ICC (275-4422) * 2100 E. Valencia Dr, Suite D, Fullerton, CA 92831 * www.icc.com