

CTP-TLV29AD

HD OVER COAX & UTP

Smart IR™

This camera is equipped with 30pcs of Smart IR™ feature which prevents overly exposed image due to sporadic IR brightness.

High Quality DC Iris Varifocal Lens

High quality DC Iris 4x Megapixel Zoom Lens (2.8-12mm) provides superior picture quality which is very important for today's high definition cameras. (Available on "VLT" models only)

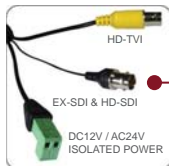
Dual HD Video Output

Both EX-SDI/HD-SDI and HD-TVI output provide Full HD @ 30fps real-time video simultaneously. This feature allows to connect up to 2 High Definition DVR's or 1 High Definition TV/Monitor at the same time.

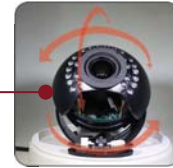
3-Axis Eash Installation Housing

The housing is made out of durable ABS plastic along with its unique housing design, and 3-Axis internal makes installation much easier than other cameras.

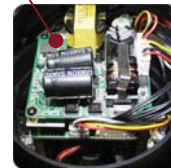
IDP™ Isolation Dual Power

Our patent pending IDP™ Isolation power will provide power to the camera more efficiently and safely by protecting the camera from surge, ground noise, and etc. (Available on DC12V/24VAC models only)

DIMENSION

* Unit : mm (Inch)

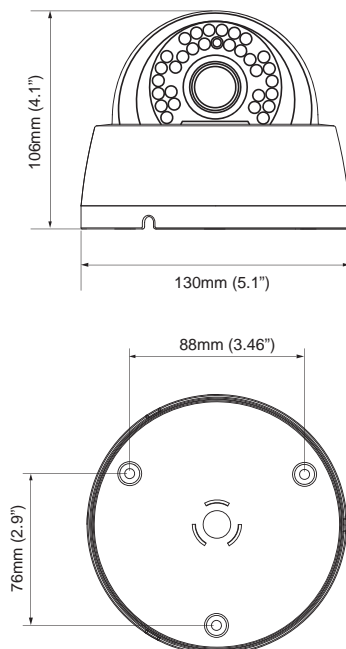

SPECIFICATION

DESCRIPTION	NTSC	PAL
IMAGE SENSOR	1/2.9" 2.4MEGAPIXEL SONY EXMOR CMOS	
EFFECTIVE PIXEL	1920 (H) x 1080 (V) = 2.4M	
SCANNING SYSTEM	PROGRESSIVE	
SYNCHRONIZATION	INTERNAL	
HORIZONTAL RESOLUTION	1080P HD	
VIDEO OUTPUT	HD-TVI, EX-SDI/HD-SDI, CVBS (OSD SELECTABLE)	
S/N (Y SIGNAL)	MORE THAN 52dB	
MIN. ILLUMINATION	0.02Lux (SENS-UP X32)	
IRIS ADJUSTMENT	ALC / ELC	
LENS	2.8~12mm MP (DC AUTO IRIS) VARIFOCAL LENS (ICR)	
ELECTRONIC SHUTTER	AUTO (1/30~1/60,000)	AUTO (1/25~1/60,000) FLK
OSD LANGUAGE	ENG / CHN / CHN[S] / JPN / KOR	
BACKLIGHT COMPENSATION	OFF / HLC / BLC / WDR	
DAY & NIGHT	COLOR / BW / EXTERN / AUTO	
WDR	OFF / LOW / MIDDLE / HIGH	
AUTO GAIN CONTROL	LEVEL (0~20) ADJUSTMENT	
WHITE BALANCE	AUTO / AUTODEXT / PRESET / MANUAL	
PRIVACY MASKING	ON / OFF (PROGRAMMABLE 16 ZONES)	
DNR	OFF / LOW / MIDDLE / HIGH	
SMART IR (ANTI-SAT)	ANTI-SET (0~20) ADJUSTMENT	
LSC	ON / OFF	
GAMMA	0.45 / 0.5 / 0.55 / 0.6 / 0.65	
DEFOG	ON / OFF	
DIGITAL ZOOM	ON / OFF (X1 ~ X8.0)	
DEAD PIXEL COMPENSATION	LIVE DPC / DPC SET	
SENS-UP	OFF / X2~X32	
MOTION	4 AREA	
DIGITAL EFFECT	OFF / V-FLIP / MIRROR / ROTATE	
COMMUNICATION	UTC	
IR LED	30 PCS	
INPUT VOLTAGE	DC 12V / AC 24V DUAL VOLTAGE (OPTIONAL)	
POWER CONSUMPTION	DC IR OFF : 200mA (MAX) / DC IR ON : 550mA (MAX) AC IR OFF : 190mA (MAX) / AC IR ON : 370mA (MAX)	
OPERATING TEMP. / HUM.	-10℃ ~ +50℃ / MAX 90% RH	
STORAGE TEMP. / HUM.	-20℃ ~ +60℃ / MAX 90% RH	