

Product Description

A versatile wall mount adaptor that allows for easy installation of several wall bracket models. Thick aluminium plate construction is powder coated black.

Specifications

Material	Aluminum
Coating	Black or White
Weight	1.97 lbs (0.89 kg)
Max Load	100 lbs (45 kg.)
Dimensions	281 mm (H) x 218 mm (W) 11.24" (H) x 8.72" (W)

Technical Drawings

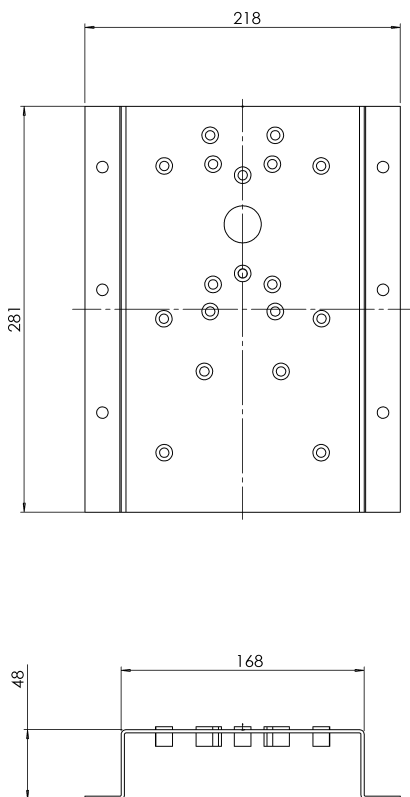

Product Image



Compatible Brackets

- [EXMB.001](#) Heavy duty wall bracket
- [EXMB.002](#) Heavy duty wall bracket
- [EXMB.003](#) Heavy duty wall bracket
- [EXMB.004](#) Heavy duty wall bracket
- [EXMB.020](#) Heavy duty L- Bracket
- [EXMB.025](#) Light duty camera bracket
- [EXMB.026](#) Dome pendant bracket
- [EXMB.045](#) Heavy duty wall bracket for pendant mounting



The EXMB.017 Wall Mount Adaptor Bracket shown with Dome Pendant Bracket EXMB.045