

# TOSHIBA



## A wall bracket for outdoor applications

- Access channel for cable
- Stainless steel bolt with rubber gasket

### Fabrication :

Body : All aluminum, gauge 8, alloy # 3105H14  
Finish : Black polyurethane coating  
Weight : 2.2 lb (1 kg)

## FSM3610 Wall mount for FB-3610

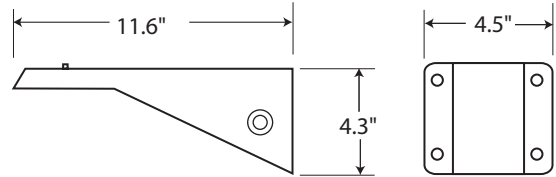

## A ceiling mount bracket for outdoor applications

- 6" x 1" NPT threaded pipe
- Mounting box with knockouts

### Fabrication:

Body : All aluminum, gauge 8, alloy # 3105H14  
Finish : Black polyurethane coating  
Weight : 3.4 lb (1.54 kg)

## FSP3610 Ceiling mount for FB-3610

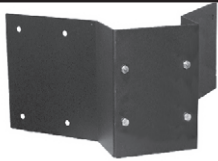
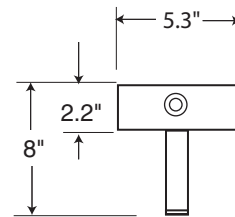

## A corner adaptor for outdoor applications

- Heavy duty
- Requires FSM3610

### Fabrication:

Body : All aluminum, gauge 8, alloy # 3105H14  
Finish : Black polyurethane coating  
Weight : 2.9 lb (1.32 kg)

## FSC3610 Corner adaptor for FB-3610

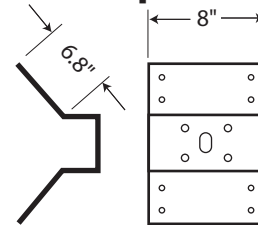

## A pole adaptor for outdoor applications

- For 3" to 8½" pole
- Stainless straps included
- Requires FSM3610

### Fabrication:

Body : All aluminum, gauge 8, alloy # 3105H14  
Finish : Black polyurethane coating  
Weight : 1.1 lb (0.5 kg)

## FSA3610 Pole adaptor for FB-3610

