

# SBP-302CM

Telescopic Pendant Mount



## SBP-302CM

|                      |  |
|----------------------|--|
| Materials            | Aluminum and steel   |
| Dimensions (WxHxD)   | Ø1.87" (47.5mm)<br>Minimum length: 4.5ft (1,372mm)<br>Maximum length: 8.0ft (2,440mm)  |
| Pipe Thread          | 1.5" NPT male (top) / 1.5" NPT female (bottom)   |
| Weight               | 7.56lb (3.43kg)  |
| Max Load             | 30lb (13.6kg)  |
| Color                | Ivory  |
| Applicable Camera    | PNP-9200RH<br>XNP-6370RH<br>SNP-6320RH/6320H/6321H/6230RH/6201H/6200RH/6200H/L6233RH/L6233H/<br>5430H/5321H/5320H/5300H/L5233H/3430H/3371TH/3371H/3120VH<br>HCP-6320H<br>SCP-3430H/3371H/3250H/3120VH/2430H/2373H/2371H/2370RH/2273H/<br>2271H/2251H/2250H |
| Applicable Mount     | SBP-300HM1/301HM2/301HM3/301HM4/300HM5/300HM6/300HM7/300HM8/<br>122HM/317HM/329HM/168HM/201HM<br>SBP-301HF/300HF/302HF<br>SBP-3701H  |
| Optional Accessories | SBP-302CMA Single Joist Ceiling Mount Adapter  |
| Cable Routing        | Cable hole   |

\* Design and specifications are subject to change without notice.

## Dimensions

Unit : inch (mm)

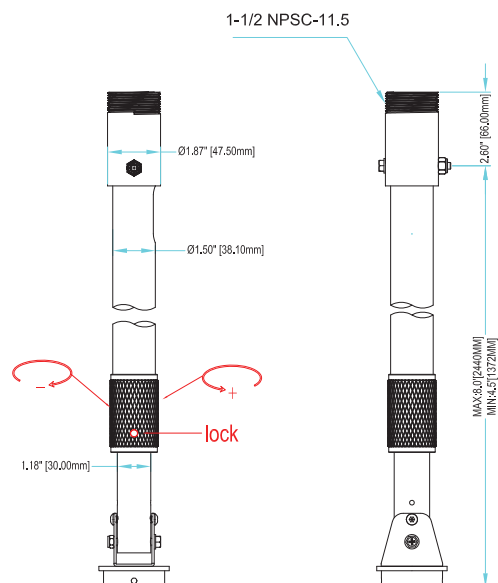

## Optional Accessories

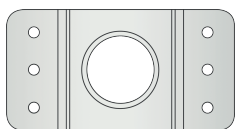

SBP-302CMA Single Joist Ceiling Mount Adapter